

MC0114525 LTE antenna

Low Profile Antenna

700/800/900/1800/1900/2100/2400/2600 MHz

LTE/GSM/ISM/UMTS/WLAN

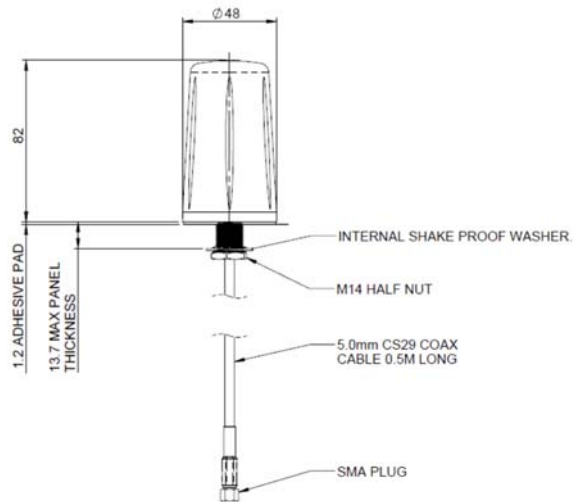

Electrical Data

Frequency Range (MHz)	764-960 / 1710-2700	
Operational Band	700/800/900/1800/1900/2100/2400/2600	
Peak Realised Gain: Isotropic	700 / 800 MHz	= 3dBi
	900 / 1800 MHz	= 4dBi
	1900 / 2100 / 2400 / 2600 MHz	= 5dBi
VSWR	<2.5:1	
Polarisation	Vertical	
Pattern	Omni-directional	
Impedance	50Ω	
Max Input Power	30 W	

Mechanical Data

Dimensions (mm)	Height 82 (3.22") / Diameter 48(1.89")
Operating Temp (°C)	-40° / +80°C (-40° / 176°F)
Material	High Impact UV Stable ABS
Colour	Black

Mounting Data

Fixing	Panel mount
Hole size (mm)	Length 5 (0.19") / Diameter 0.5 (19.6")

Cable Data

Type	5mm low loss coax
Thickness (mm)	5(0.19")
Length (m)	0.5(19.6")
Termination	SMA plug