

MC0114020-DUAL YAGI antenna

8 element Yagi for Cellular and SMR Applications
Use for remote & rural locations

ISM/GSM/UMTS

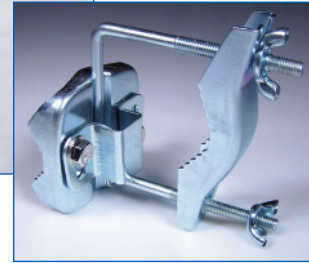
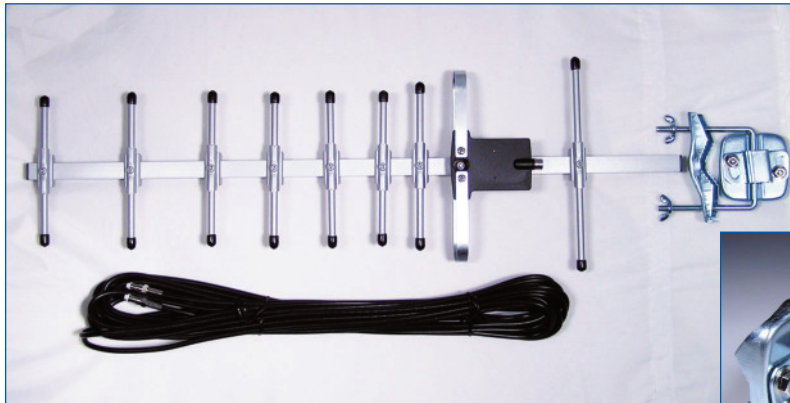

Specifications:

Frequency:	860 - 960 / 1800 MHz + UMTS 1930 / 2170 MHz
Gain:	11 dBi
V.S.W.R.:	< 1.5 : 1
Cable:	10m RG58, 2 x FME (female)
Connector:	FME (male)
Max. Power:	100W
Polarization:	vertical
Impedance:	50 Ohm
Weight:	260 g
Boom Length:	57,5 cm
Longest Element:	18,5 cm

