

REV	DESCRIPTION	DRAWN	DATE

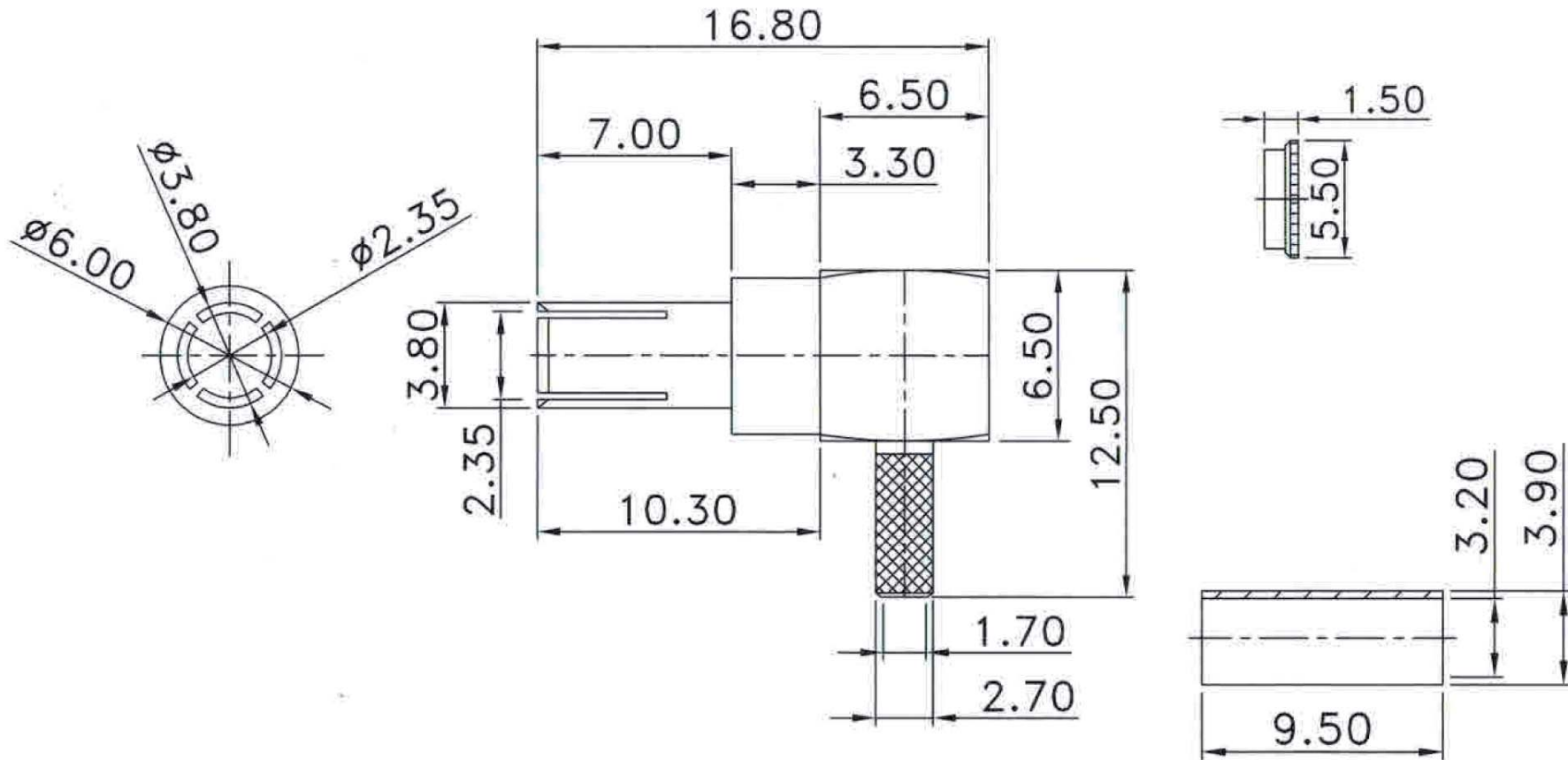

6	CAP	1	BRASS	NICKEL
5	FERRULE	1	BRASS	NICKEL
4	DIELECTRIC	1	TEFLON	NONE
3	PIN	1	PHOS BRONZE	GOLD
2	BODY	1	BERYLLIUM	NICKEL
1	BODY	1	BRASS	NICKEL
NO	Description	Qty	Material	Finish

UNLESS OTHERWISE SPECIFIED
 1. REMOVE ALL BURRS.
 2. BREAK ALL CONNERS & EDGES CO.15 MAX.
 3. CHAMFER 1ST & LAST THREADS 45°.
 4. DIAMETERS ON COMMON CENTERS.
 TO BE CONCENTRIC WITHIN 0.1 T.I.R.
 5. ALL DIMENSIONS ARE AFTER PLATING.

* MAJOR DIMENSION
 UNLESS OTHERWISE NOTED TOLERANCES
 0.5-6=±0.2
 6-30=±0.4
 30-120=±0.6
 120-315=±1.0
 ANGLES=±1°

APPROVED
 CHECKED
 DRAWN andrew

MC-1523126
 TITLE
 TS9 MALE R/A CRIMP FOR RG174
 DRAWING NO. REV A
 FILE NO.

SCALE 6/1 UNIT MM DRAWN DATE 03/07/29